

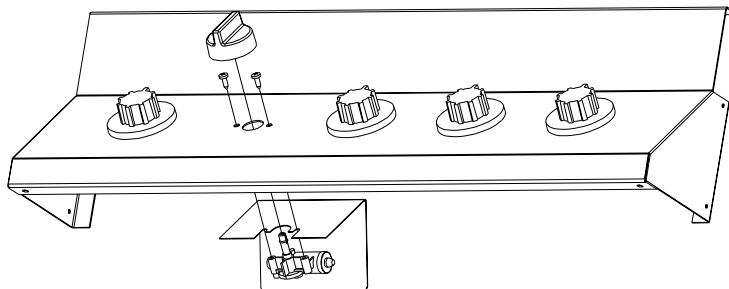

Instructions for Replacing Igniters and Electrode Ignition Systems

Rotary Igniter Replacement

1. To remove the rotary igniter, first remove the igniter knob by pulling it away from the control panel.
2. Disconnect the electrode wires from the igniter.
3. Remove the 2 screws fastening the assembly to the control panel. The heat shield and igniter can now be removed from the underside of the control panel.
4. To replace, connect the wires to the igniter, then holding it in place underneath the control panel, start screwing in the 2 fastening screws. Slide the heatshield back into place between the igniter and the underside of the control panel so that the slots line up with the mounting screws. Tighten the 2 fastening screws.



Electronic Igniter Replacement

1. Unscrew the igniter push button knob. Remove the battery.
2. Disconnect the electrode wires from the underside of the igniter.
3. Remove the black nylon nut fastening the igniter to the control panel.
4. Pull the igniter away from the underside of the control panel.
5. To replace the igniter, reverse the previous steps.

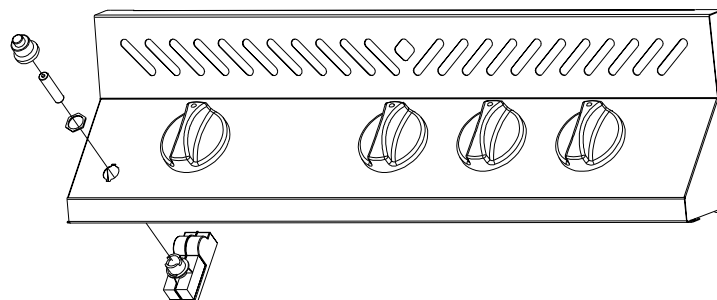

Electrode Replacement

1. Turn off the gas supply to the grill. Remove warming rack, cooking grids and sear plates.
2. Disconnect the electrode wires from the igniter on the underside of the control panel.
3. Bend the collector box in the opposite direction from the opening in the box.
4. To replace, feed the electrode wire through the opening until the box is against the base of the grill. Refasten the collector box and electrode to the base with the 1/4" hex head screw. Bend the collector box closed so that it is parallel to the burner with its opening facing the burner. Attach the wire back to the igniter.

